

Item No.	Type	Sub	Part No.	Description (* See Service changes on the bottom)	Qty	Unit
1			151726-8	LOCATOR COMPLETE	1	PC.
2			421631-6	DUST SEAL RING	1	PC.
3			213373-4	O RING 22	1	PC.
4			416994-3	LOCK RING	1	PC.
5			232154-7	LEAF SPRING	1	PC.
6			266050-7	TAPPING SCREW 4X30	3	PC.
7			153497-3	GEAR HOUSING COMPLETE	1	PC.
8			421766-3	RING 20	1	PC.
9			232050-9	LEAF SPRING	1	PC.
10			216001-0	STEEL BALL 3.5	1	PC.
11			324290-4	SPINDLE	1	PC.
12			233126-5	COMPRESSION SPRING 6	1	PC.
13			268099-3	COLLARED PIN 8	1	PC.
14			227056-0	SPUR GEAR 36	1	PC.
15	1		211014-6	BALL BEARING 606	1	PC.
	2		211012-0	BALL BEARING 606ZZ	1	PC.
16			226133-5	GEAR COMPLETE 17-35	1	PC.
17			267017-8	FLAT WASHER 8	1	PC.
19			216213-5	WASHER 824	1	PC.
20			216415-3	THRUST NEEDLE CAGE 821	1	PC.
21			216212-7	WASHER 821	1	PC.
22			153499-9	GEAR HOUSING COVER COMPLETE	1	PC.
23	1		210007-0	* BALL BEARING 608VV	1	PC.
	2		210005-4	* BALL BEARING 608DDW	1	PC.
24			510053-6	ARMATURE ASS'Y 115V	1	PC.
		INC.	240022-0	FAN 52	1	PC.
		INC.		Item No. 23,25,26,44		
25			681636-0	INSULATION WASHER	1	PC.
26			211021-9	BALL BEARING 607LLB	1	PC.
27			421479-6	RUBBER RING 19	1	PC.
28			416993-5	BAFFLE PLATE	1	PC.
29			266147-2	TAPPING SCREW 4X55	2	PC.
30			633441-1	FIELD 115V	1	PC.
31			417625-7	HOOK	1	PC.
32	1		183285-4	MOTOR HOUSING	1	PC.
	1	INC.		Item No.33		
	2		188628-5	MOTOR HOUSING	1	PC.
	2	INC.		Item No.33		
	3		450718-7	MOTOR HOUSING	1	PC.
33			819063-3	MAKITA LABEL (F/ TYPE1&2 MOTOR HSG)	1	PC.
35			643952-8	BRUSH HOLDER	1	PC.
36	1		191927-6	CARBON BRUSH CB-407 2PC/SET (W/O ORIGIN)	1	SET
	2		195007-0	CARBON BRUSH CB-407 2PC/SET (W/ ORIGIN)	1	SET
37			664891-9	CORD W/PLUG 2P-18-2.5M, SJ	1	PC.
38			682559-5	CORD GUARD 8	1	PC.
39	1		687063-9	CORD CLAMP (STRAIN RELIEF)	1	PC.
39	2		687123-7	CORD CLAMP (STRAIN RELIEF)	1	PC.
40			265995-6	TAPPING SCREW 4X18	2	PC.
41			651978-6	SWITCH C3MA-2L	1	PC.
42	1		151961-8	HANDLE COVER COMPLETE	1	PC.
	1	INC.	263002-9	RUBBER PIN 4	2	PC.
	2		158710-4	HANDLE COVER COMPLETE	1	PC.
	2	INC.	263002-9	RUBBER PIN 4	2	PC.

Item No.	Type	Sub	Part No.	Description (* See Service changes on the bottom)	Qty	Unit
43			265999-8	TAPPING SCREW 4X25	3	PC.
44			253139-0	FLAT WASHER 8	1	PC.
45			643953-6	BRUSH HOLDER	1	PC.
46			442136-3	* GASKET (Added)	1	PC.
47			256157-7	* PIN 3 (Added)	1	PC.

ACCESSORIES

- See catalogue or visit www.makita.ca for optional accessory -

A01			784211-2	PHILLIPS INSERT BIT 2-25	1	PC.
	Opt.		784212-0	PHILLIPS INSERT BIT 1-25	1	PC.
A02			784801-1	MAGNETIC BIT HOLDER 6.35-76	1	PC.
	Opt.		784807-9	MAGNETIC BIT HOLDER 6.35-60	1	PC.

SERVICE CHANGES

1. Changes on Ball Bearing, Gasket & Pin

Item No.	Description	Type 1	Type 2
23	Ball Bearing	210007-0	210005-4
46	Gasket	-----	442136-3
47	Pin 3	-----	256157-7

Above parts are completely interchangeable as a set.

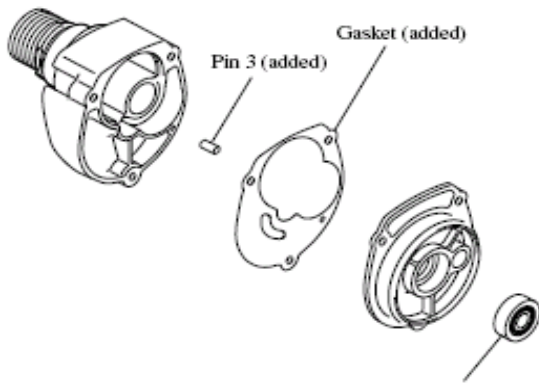

► Current	► New
Ball Bearing 608VV	Ball Bearing 608DDW

Note: Ball Bearing 608DDW is better sealed.